



# Opti-Feed

Automated Feeding Systems

Opti-Feed 1000 Vack  
Opti-Feed 3000 Vack  
Opti-Feed 3000  
Opti-Feed 6000 Vack  
Opti-Feed 6000



**Optimization of staff and wood resources**

# Table of content

# Automated feeding systems

- Opti-Feed 1000, 3000 and 6000

**03** Automated feeding systems

**04** Opti-Feed 1000 Vack

**06** Opti-Feed 3000 Vack

**08** Opti-Feed 3000

**10** Opti-Feed 6000 Vack

**12** Opti-Feed 6000

**14** Technical data

**16** Additional products

**18** System TM service

## Automated feeding systems

System TM offers a wide range of standard, well-proven automated feeding systems for automation of main machines such as:

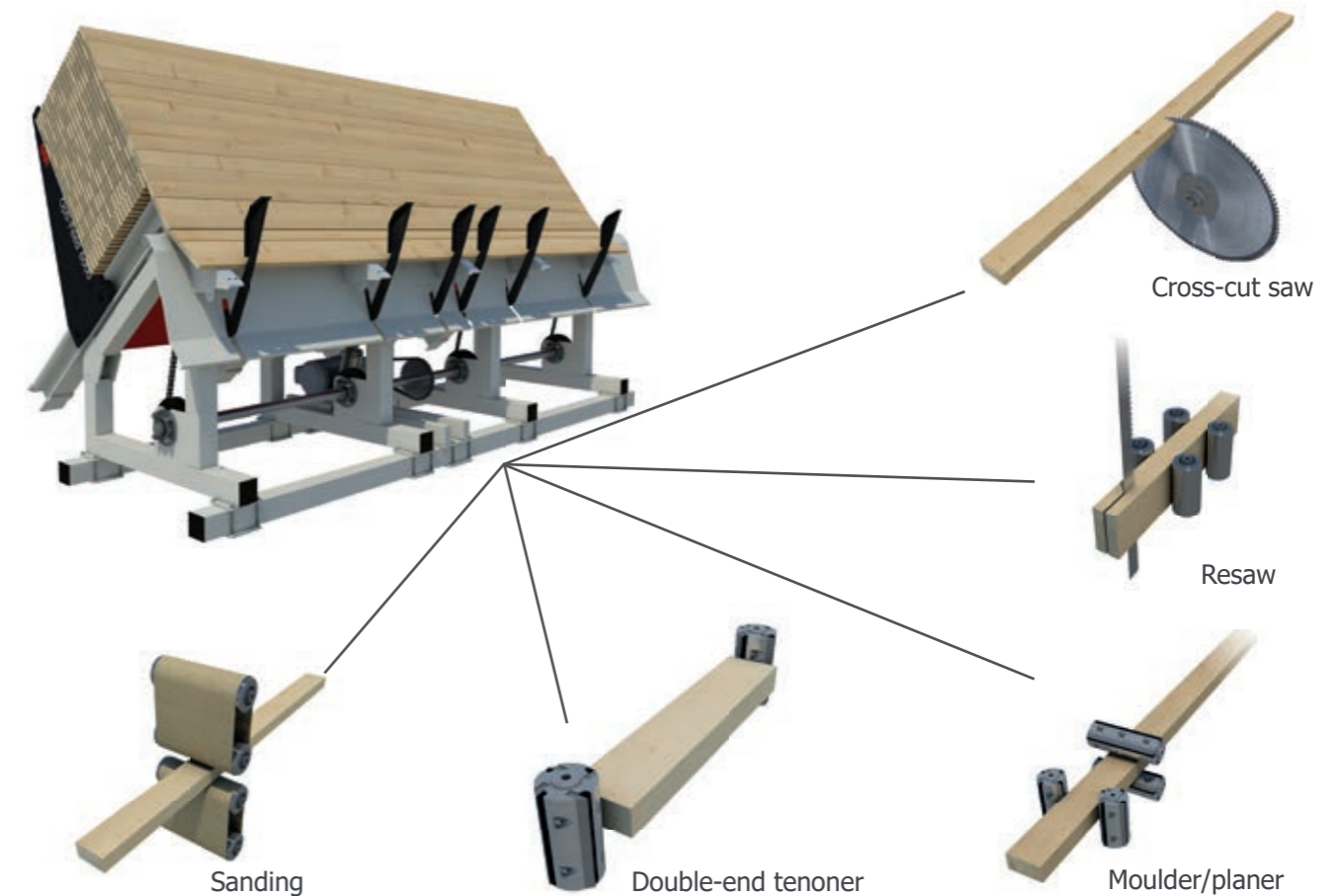

The automated feeding systems from System TM are designed to dramatically increase the capacity of the main machine and reduce labor costs. With System TM's Opti-Feed series we are able to advise you on - and supply - the right solution to fulfil your specific requirements and demands to obtain a more efficient and more profitable production.

The automated feeding system gives you full utilization of the capacity of your main machines and optimize on your staff and wood resources.

► **Make a wise move**

**- let an Opti-Feed system from System TM do all the hard and repetitive work!!**

# Opti-Feed 1000 Vack

## Automated feeding system - Opti-Feed 1000 Vack

Opti-Feed 1000 Vack is a vacuum de-stacking unit which is able to feed complete or partial layers of workpieces in the correct order into different main machines such as cross-cut saws, moulding machines, double-end tenoners, resaws and sanding machines.

The Opti-Feed 1000 Vack consists of a vacuum head suitable of feeding short workpieces from 380 – 1,600 mm (15"-63"). It has a capacity of feeding up to 5 layers per minute of both random or uniform lengths and widths. The vacuum head is equipped with check valve technology, which automatically recognizes and closes the check valves in areas without workpieces. This ensure very secure handling and lifting of all layers, random lengths and widths without any adjustment of the vacuum heads.

By a modular design the Opti-Feed 1000 Vack de-stacking unit is suspended from a portal, enabling de-stacking of layers from packs standing directly on the floor without production stop of the main machinery.

### Advantages

- ▶ De-stacking from multiple destinations
- ▶ De-stacking to multiple destinations
- ▶ Releases labor from hard and repetitive work
- ▶ Capacity increase of the main machines
- ▶ Gentle handling without damaging workpieces or layers
- ▶ Minimum space requirement
- ▶ Feeding of random lengths and widths

### Features

- ▶ Automatic removal of stabilizing or drying sticks
- ▶ Stick collector
- ▶ Automatic pack transport
- ▶ Receiving chain conveyor
- ▶ Customized features upon request

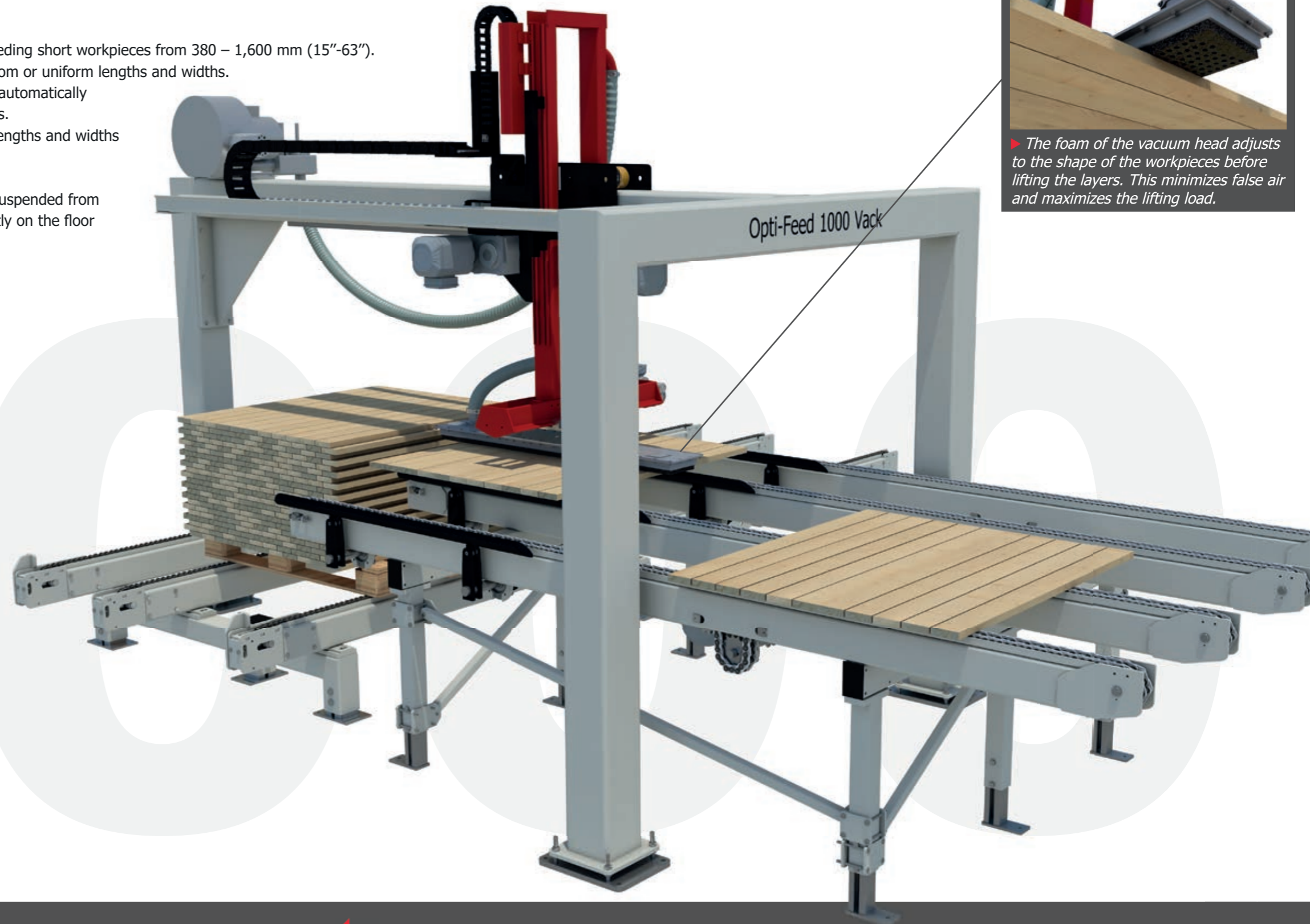

▶ The foam of the vacuum head adjusts to the shape of the workpieces before lifting the layers. This minimizes false air and maximizes the lifting load.

# Opti-Feed 3000 Vack

## Automated feeding system - Opti-Feed 3000 Vack

Opti-Feed 3000 Vack is a vacuum de-stacking unit which is able to feed complete or partial layers of workpieces in the correct order into different main machines such as cross-cut saws, moulding machines, double-end tenoners, resaws and sanding machines.

The Opti-Feed 3000 Vack consists of two vacuum heads suitable for feeding short workpieces from 380 – 2,500 mm (15”-98”). It has a capacity of feeding up to 5 layers per minute of both random or uniform lengths and widths. The vacuum head is equipped with check valve technology, which automatically recognizes and closes the check valves in areas without workpieces. This ensure very secure handling and lifting of all layers, random lengths and widths without any adjustment of the vacuum heads.

By a modular design the Opti-Feed 3000 Vack de-stacking unit is suspended from a portal, enabling de-stacking of layers from packs standing directly on the floor without production stop of the main machinery.

### Advantages

- ▶ De-stacking from multiple destinations
- ▶ De-stacking to multiple destinations
- ▶ Releases labor from hard and repetitive work
- ▶ Capacity increase of the main machines
- ▶ Gentle handling without damaging workpieces or layers
- ▶ Minimum space requirement
- ▶ Feeding of random lengths and widths

### Features

- ▶ Automatic removal of stabilizing or drying sticks
- ▶ Stick collector
- ▶ Automatic pack transport
- ▶ Receiving chain conveyor
- ▶ Customized features upon request



▶ The check valve technology recognizes and closes the valves in areas without workpieces. This ensure secure lifting of layers without any adjustment

# Opti-Feed 3000

## Automated feeding system - Opti-Feed 3000

Opti-Feed 3000 is a de-stacking unit which is able to feed complete or partial layers of workpieces in the correct order into different main machines such as cross-cut saws, moulding machines, double-end tenoners, resaws and sanding machines.

The Opti-Feed 3000 consists of a mechanical layer gripper system, suitable for feeding short workpieces from 380 – 2,500 mm (15"– 98"). It has a capacity of feeding up to 5 layers per minute of uniform lengths and random widths. The layer gripper system is equipped with rubber profiles, picking up the layers by gripping each end of the workpieces. This ensures a secure handling and lifting of all layers directly from the pack of workpieces.

By a modular design the Opti-Feed 3000 destacking unit is suspended from a portal, enabling de-stacking of layers from packs standing directly on the floor without production stop of the main machinery.

### Advantages

- ▶ De-stacking from multiple destinations
- ▶ De-stacking to multiple destinations
- ▶ Releases labor from hard and repetitive work
- ▶ Capacity increase of the main machines
- ▶ Gentle handling without damaging workpieces or layers
- ▶ Minimum space requirement
- ▶ Feeding of random widths
- ▶ Destacking of narrow workpieces

### Features

- ▶ Automatic removal of stabilizing or drying sticks
- ▶ Stick collector
- ▶ Automatic pack transport
- ▶ Receiving chain conveyor
- ▶ Customized features upon request



▶ The mechanical layer gripper consist of flexible rubber profiles, which ensure secure lifting of all workpieces in the layers.

# Opti-Feed 6000 Vack

## Automated feeding system - Opti-Feed 6000 Vack

Opti-Feed 6000 Vack is a vacuum de-stacking unit which is able to feed complete or partial layers of workpieces in the correct order into different main machines such as cross-cut saws, moulding machines, double end tenoners, resaws and sanding machines.

The Opti-Feed 6000 Vack consists of multiple vacuum heads suitable for feeding long workpieces from 1,200 – 6,000 mm (4' - 20'). It has a capacity of up to 4 layers per minute of both random and uniform lengths and widths. The vacuum heads are equipped with check valve technology, which automatically recognizes and closes the check valves in areas without workpieces. This ensures very secure handling and lifting of all layers, random lengths and widths without any adjustment of the vacuum heads.

By a modular design the Opti-Feed 6000 Vack de-stacking unit is suspended from a portal, enabling de-stacking of layers from packs standing directly on the floor without production stop of the main machinery.

### Advantages

- ▶ De-stacking from multiple destinations
- ▶ De-stacking to multiple destinations
- ▶ Releases labor from hard and repetitive work
- ▶ Capacity increase of the main machines
- ▶ Gentle handling without damaging workpieces or layers
- ▶ Minimum space requirement
- ▶ Feeding of random lengths and widths

### Features

- ▶ Automatic removal of stabilizing or drying sticks
- ▶ Stick collector
- ▶ Automatic pack transport
- ▶ Receiving chain conveyor
- ▶ Customized features upon request

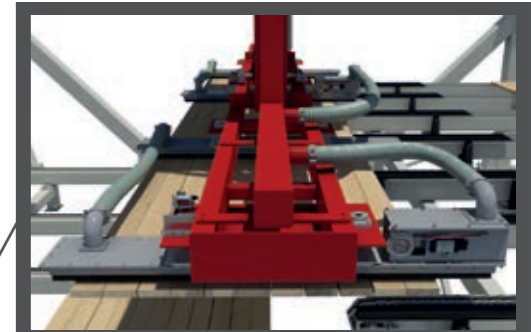
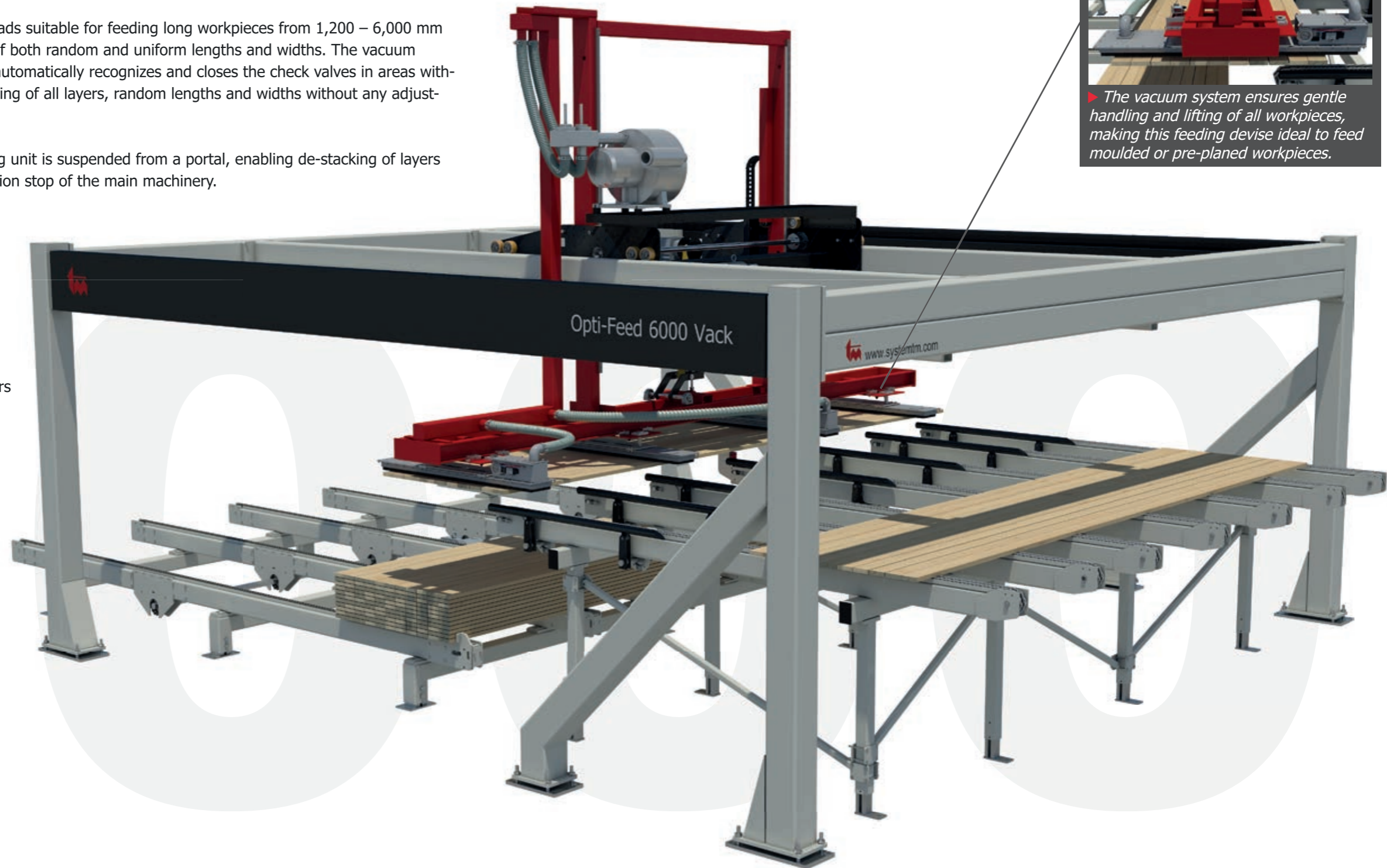

▶ The vacuum system ensures gentle handling and lifting of all workpieces, making this feeding device ideal to feed moulded or pre-planed workpieces.

# Opti-Feed 6000

## Automated feeding system - Opti-Feed 6000

The Opti-Feed 6000 is designed to feed workpieces to different main machines such as for example cross-cut saws, moulding machines, resaws and rip saws. The Opti-Feed 6000 is a mechanical de-stacking unit suitable of feeding long workpieces from 1,200 - 6,100 mm (4' - 20') at a high capacity by uniform or random lengths.

The de-stacking unit can consist of single or multiple machine modules, combined to fulfill the needed application with regards to capacity, processes and space availability. Packs can easily and automatically be replaced during operation - without stopping the main machinery which can ensure the production capacity.



► The mechanical feeding system can be equipped with optional features such as equipment for edge protection and noise reduction.

### Advantages

- High capacity
- Feeding of random lengths and widths
- Infeed speed is adjusted to the speed of the main machines
- Releases labor from hard and repetitive work
- Capacity increase of the main machines
- Destacking of narrow workpieces

### Features

- Automatic removal of stabilizing or drying sticks
- Stick collector
- Automatic pack transport
- Trim saw
- Equipment for edge protection and controlled workpiece feeding
- Automatic measuring of core bend
- Turning devices for best orientation of every single workpiece
- Reject gate
- Customized features upon request

# Technical data

## Overview of the data for Opti-Feed series

	<b>Opti-Feed 1000 Vack</b>	<b>Opti-Feed 3000 Vack</b>	<b>Opti-Feed 3000</b>	<b>Opti-Feed 6000 Vack</b>	<b>Opti-Feed 6000</b>
Board length	380 - 1,600 mm (15" - 63")	380 - 2,500 mm (15" - 98")	380 - 2,500 mm (15" - 98")	1,200 - 6,300 mm (4' - 20')	1,200 - 6,300 mm (4' - 20')
Board width	75 - 1,225 mm (3" - 48")	63 - 1,225 mm (2.5" - 48")	50 - 300 mm (2" - 12")	63 - 1,225 mm (2.5" - 48")	50 - 300 mm (2" - 12")
Board thickness	15 - 35 mm (0.6" - 1.4")	15 - 50 mm (0.6" - 2")	15 - 100 mm (0.6" - 4")	15 - 50 mm (0.6" - 2")	15 - 100 mm (0.6" - 4")
Number of vacuum heads	1	2	None	4	None
Random length	Yes	Yes	No	Yes	Yes
Maximum length variation	30 %	30 %	+/- 5 mm (0.25")	30 %	30 %
Maximum work-piece weight	Depends of board dimension	Depends of board dimension	20 kg (44 lb)	Depends of board dimension	40 kg (88 lb)
Maximum layer weight	30 kg (66 lb)	100 kg (220.5 lb)	80 kg (176.4 lb)	200 kg (441 lb)	400 kg (882 lb)
Maximum pack height	1,225 mm incl.pallet (48")	1,225 mm incl. pallet (48")	1,225 mm incl. pallet (48")	1,225 mm incl. pallet (48")	1,225 mm incl. pallet (48")
Maximum pack width	1,225 mm (48")	1,225 mm (48")	1,225 mm (48")	1,225 mm (48")	1,225 mm (48")
Capacity	5 layers per minute	5 layers per minute	5 layers per minute	4 layers per minute	6 layers per minute
Optional capacity	8 layers per minute	8 layers per minute	8 layers per minute	8 layers per minute	10 layers per minute

All of the above data can be customized upon request



# Additional products

## System TM A/S

All products and system solutions from System TM can be equipped with an automatic handling or scanning system for best lumber utilization and capacity, with a minimum use of labor power.

In order to meet all customer demands, our range of material handling systems consist of both standard and fully customized system solutions.



**OPTI-KAP**  
Optimizing cross-cut saws



**OPTI-STACK**  
Automated stacking systems



**OPTI-JOINT**  
Automated finger jointing systems

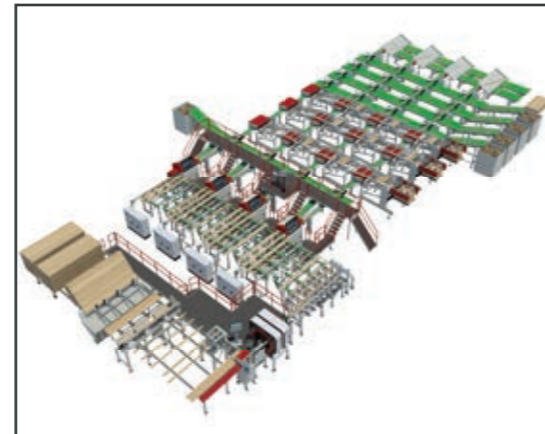

**OPTI-SOLUTION**  
Customized system solutions

## MICROTEC

All products and system solutions from System TM can be equipped with an automatic scanning system for best lumber utilization and production optimization.

The scanner partner of System TM is a technology leader within the scanning industry. Their scanners are extremely reliable and accurate when recognizing wood defects in order to automate, streamline and optimize your production.

The identification of the characteristics of the lumber, is based on a Multi-Sensor scanning technology that recognizes knots, cracks, pitch pockets, holes, stains, waness and other board defects as well as their location. With unheard precision, and at a very high speed, the sensors scan the boards for the best possible lumber utilization.

A product or system solution from System TM, combined with today's scanning technology and optimizing software, ensure the best production optimization, at an unbeatable high capacity.

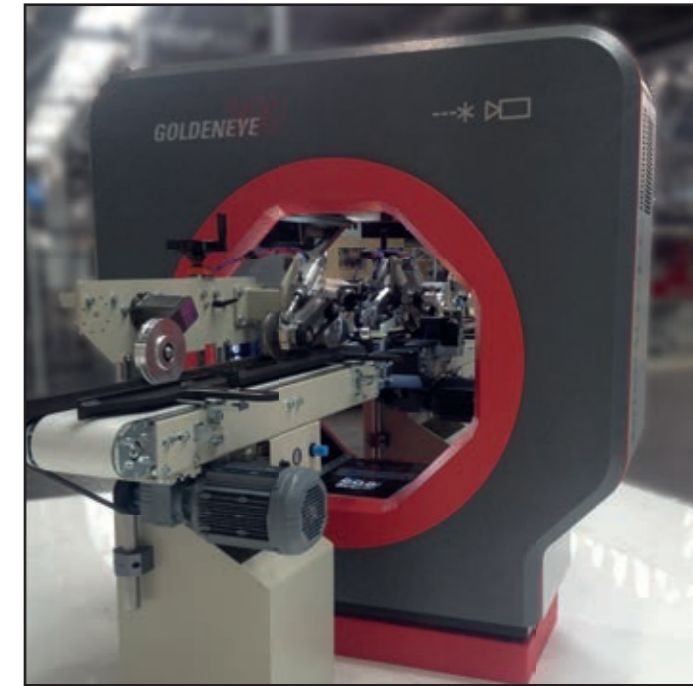

► The Microtec Multi-Sensor Scanner Goldeneye 300 series



► The multi sensor scanning technology scan the workpieces for best wood utilization.

# System TM service

## Optimal performance with a strong service- and support team

System TM service is a key strategic business unit. The service department focuses on providing you with service and support and we continuously develop our services to meet your requirements.

System TM service offers you services to ensure uninterrupted operation, with the best possible productivity and utilization. Systematic maintenance minimizes production downtimes, and ensures smooth operation with minimum risk of unexpected events.

System TM service is a team of professionally educated, trained and experienced service engineers and technicians ready to provide full technical support and services. With more than 35 years of experience designing, building, integrating and maintaining automated wood material handling systems, System TM is highly qualified to offer total service and support.

## This includes:

- ▶ Service and maintenance contracts
- ▶ Customized spare part kit for each customer to provide a successful start
- ▶ Modification, upgrading and extension of existing machines, controls and software
- ▶ Relocation, renovation, installation and start-up of machine installations
- ▶ Production and system analysis and optimization
- ▶ Staff/operator education on how to handle and maintain the machines
- ▶ Advisory and consultancy service
- ▶ Spare parts and enhancements
- ▶ Warranty
- ▶ Helpdesk and online telephone support - 24 hours worldwide





System TM A/S  
Skovdalsvej 35, P.O. Box 249  
DK-8300 Odder, Denmark

(Office) + (45) 86 54 33 55  
(Fax) + (45) 86 54 32 19  
E-mail: [tm@systemtm.com](mailto:tm@systemtm.com)  
[www.systemtm.com](http://www.systemtm.com)



**Optimization of staff and wood resources**